

New system

 **LEGEND***art*

Door
Window



Combination of an Elegant Design with Excellent Performance

Legend Art Door & Window systems brings aesthetics and elegance to the front by adapting to the style of your spaces with its perfect design & detailings. Our Legend Art Door & Window system adds value to your spaces while keeping comfort intact.

With its modern & simple design, colour alternatives and elegant finishing, the system stresses its importance to aesthetics in harmony with the architecture and decoration of the spaces.

Superior Insulation: The heat transmission coefficient (U_f) of the Legend Art Door & Window systems, is determined as 1.1 - 1.5W /m²k. Thanks to its elegant thin ear design, it allows the use of thick glass, offering a performance of less than 0.9 W / m²K in window thermal insulation.

Static Power: Even in regions where the wind is high, Legend Art Door & Window system provides the most suitable solutions with static centre & facade profiles.

Acoustic Performance: With the existing insulation properties of PVC & the multi-compartment structure it even transforms the areas that require maximum acoustic insulation.

TECHNICAL SPECIFICATION

- 70mm Series of Windows & Doors Casement System
- 5 Chamber Design
- Co-extruded TPE Grey and Black Gasket, Doublefin & Woolpile
- Glass Thickness options : 6mm, 8mm, 10mm, 24mm, 30mm, 36mm, 44mm & 58mm
- Low Heat Transmission Coefficient with U_f value 1.1 - 1.5 w/m²k, > 0.9 w/m²k
- Air Permeability as per BS EN 12207 up to Class 4
- Water Tightness as per BS EN 12208 up to Class 9A
- Wind resistance as per IS 875 - Part III
- Available in white colour and variety of Solid & Wooden finishes

CERTIFICATE
of the characteristics
No. 22 106 CV

Product specification:

Frame and sash	Frame: P12560 / frame reinforcement: P12071 galvanized steel 1,2 mm thick; sash: P12570 / sash reinforcement: P12072 galvanized steel 1,2 mm thick
Other profiles	glazing bead P12149
Insulating panel	Double insulating sandwich panel 46,0 mm thick of composition: 2x (0,6 mm PVC – 21,8 mm thermal insulation XPS – 0,6 mm PVC)
Sealing	Inner: 10581, outer: 16990; outer glazing gasket: 16990; all gaskets profiles are welded in the corners; inner glazing gasket: P12140 belt and cut in the corner
Hardware	All-Peripheral Standard hardware FFB, 7 point closure, 2 tilt and turn hinges, controlling by handle

Product characteristic:

Title of tested parameter	Testing method	Results
Thermal transmittance U_i	ČSN EN 12412-2:2004	1,1 W/(m ² .K)

This certificate confirms the result of the test of the characteristic of the tested specimen of the above product:

The U_i result complies with ČSN 73 0540-2:2011 for the recommended thermal transmittance:
 $U_i = 1,1 \leq U_{rec,20} = 1,3 \text{ W/(m}^2\text{.K)}$

Documents: Test report of accredited laboratory No. 415600452-02, ATL No. 1007.1, ITC – CSI Division dated on 2022-05-16

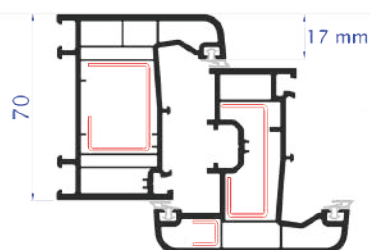
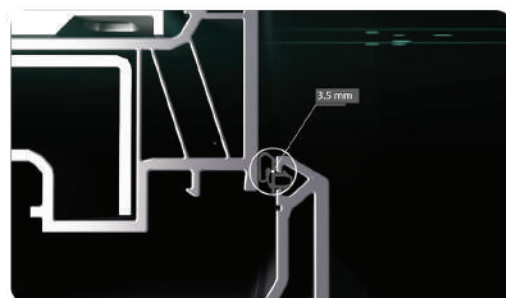
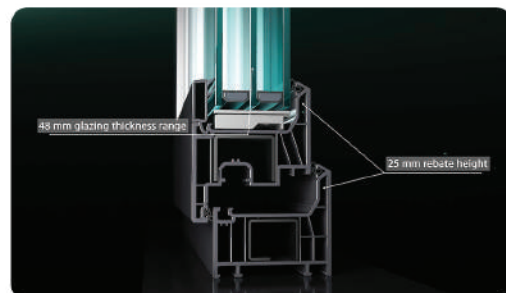
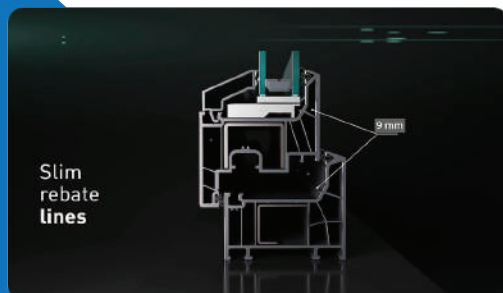

70mm ZENDOW



60mm EVEREST MAX

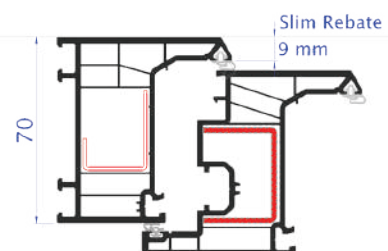

70mm LEGEND ART